

three challenges

three challenges

1. a fee-for-services industry

three challenges

1. a fee-for-services industry
2. limited engagement methods

three challenges

1. a fee-for-services industry
2. limited engagement methods
3. architecture's cultural assumptions

three challenges

three challenges

three opportunities

three opportunities

1. Early Advocacy
2. limited investment in engagement
3. architecture's cultural assumptions

three opportunities

1. Early Advocacy
2. Advancing Engagement Methods
3. architecture's cultural assumptions

three opportunities

1. Early Advocacy
2. Advancing Engagement Methods
3. A Challenge to Architecture

1. Early Advocacy

1. Early Advocacy

Project: Valongo Wharf and the Circuit of African Heritage

Location: Rio de Janeiro, Brazil

Organization: The Landscape Architecture Foundation



Desembarque, 1835.





1870

1880

1890

1900

1910

1920

1930

1940

1950

1960

1970

1980

1990

2000

2010

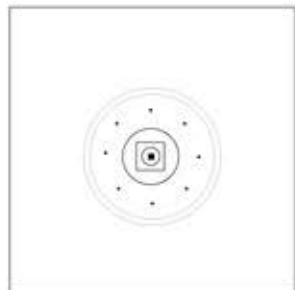
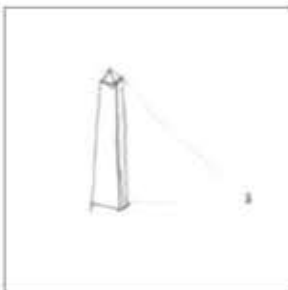
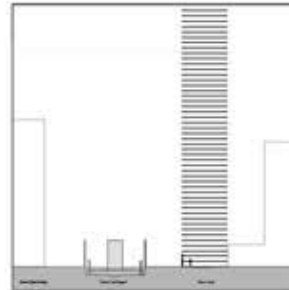
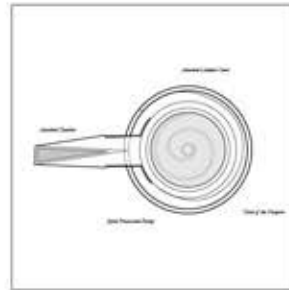
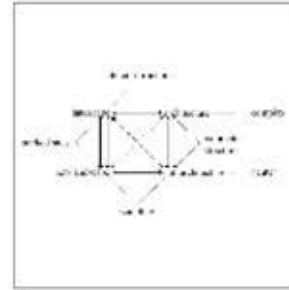
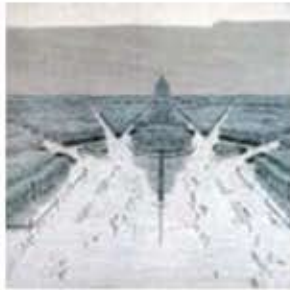



300 Million Years Ago

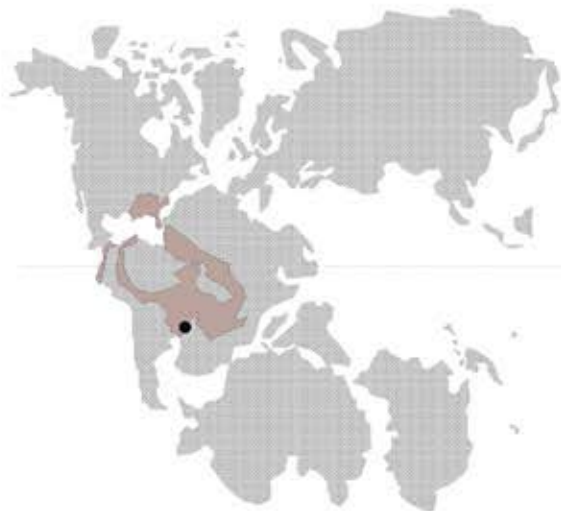

150 Million Years Ago



150 Years Ago



latosolic tropical red soils



the Valongo Wharf site, over 300 million years

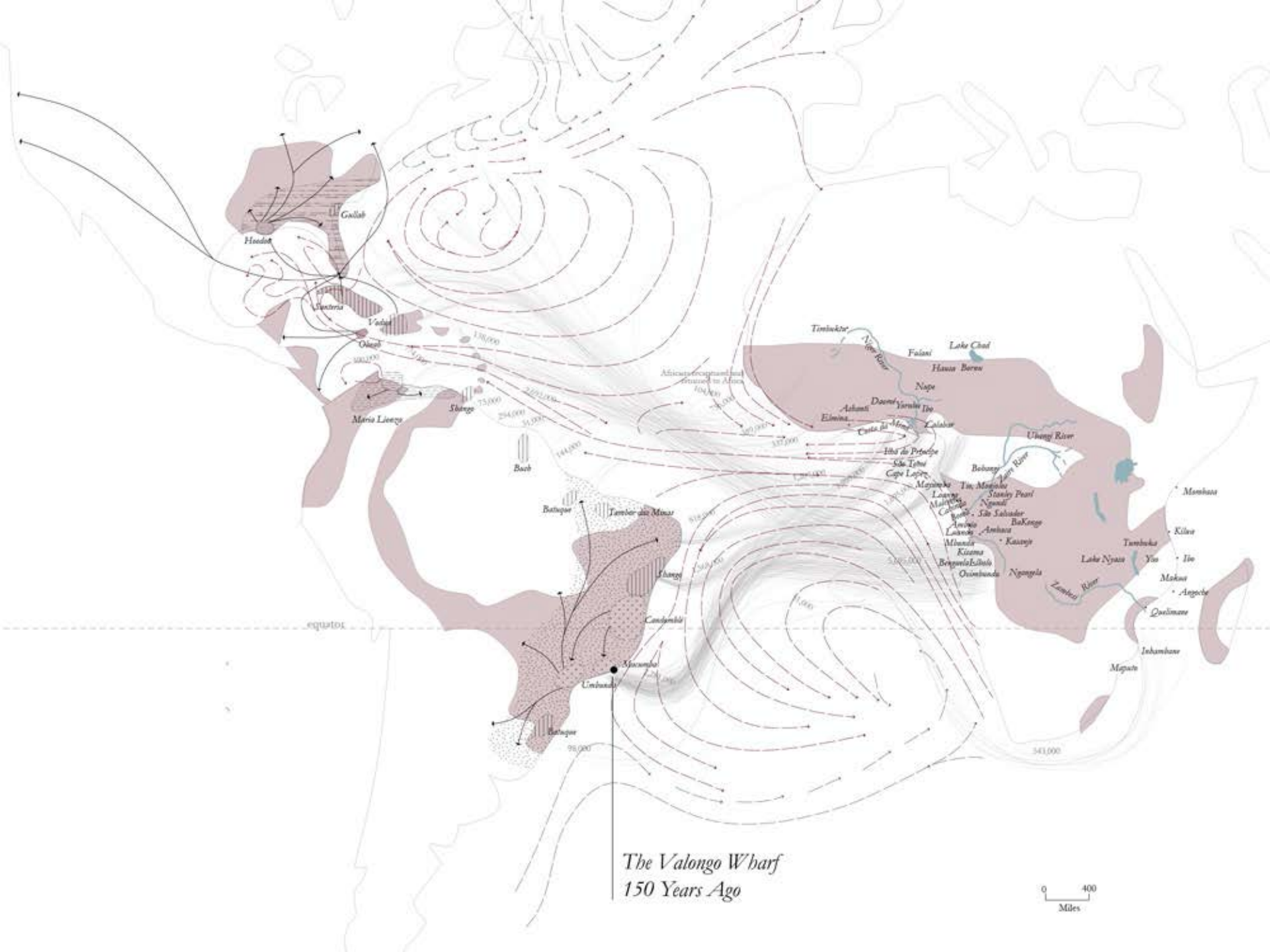

*The Valongo Wharf
150 Years Ago*



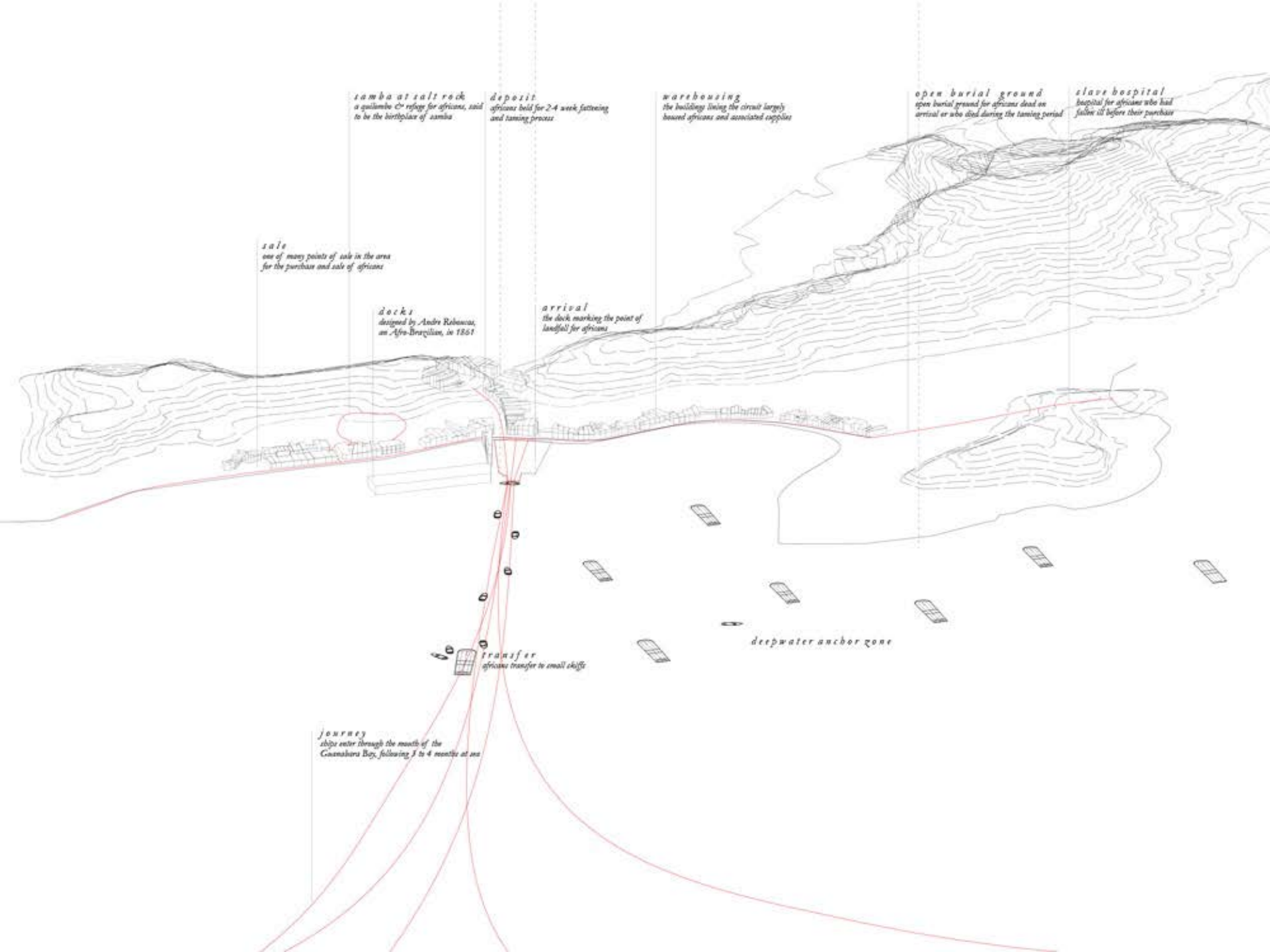

samba at salt rock
a quilombo & refuge for africans, said to be the birthplace of samba

deposit
africans held for 2-4 week fattening and taming process

warehouseing
the buildings lining the circuit largely housed africans and associated supplies

open burial ground
open burial ground for africans dead on arrival or who died during the taming period

slave hospital
hospital for africans who had fallen ill before their purchase

sale
one of many points of sale in the area for the purchase and sale of africans

docks
designed by Andre Rebouças, an Afro-Brazilian, in 1861

arrival
the dock marking the point of landfall for africans

transfer
africans transfer to small skiffs

deepwater anchor zone

journey
ships enter through the mouth of the Guanhara Bay, following 3 to 4 months at sea

OLYMPIC AND MAYORAL REDEVELOPMENT PLAN

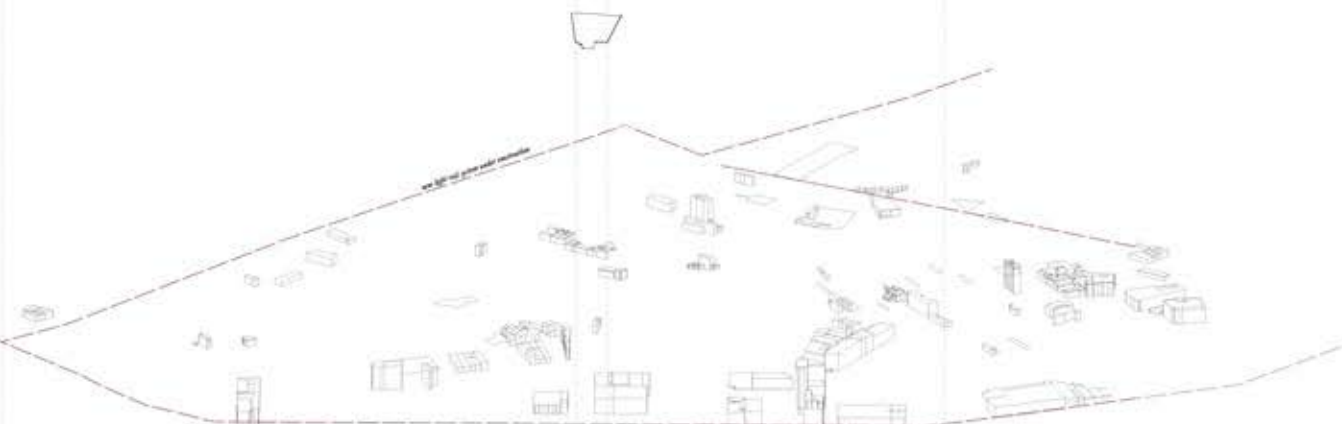

avenida via branc
major connector to the financial district

two courtyards
one of two open-air courtyards in the financial district and a relic of the reimagining of the area

central terminal
former industrial warehouse now serving as passenger-rail terminal

guelmunda da pedra da cal
the former museum courtyard remains the site of many of the Douglas cultural events

central station
premier rail facility with two-level station, plus many of the Douglas's bar

ruelle da presidente
five-block-long street, named in a celebration of the 100th anniversary of the city

remains from Brazil
over 1000, remains of the neighborhood have survived in just minutes of the time being back to its use as a great tourist ground

marra da canoalada
a highly residential neighborhood being developed primarily for its cultural activities and neighborhood uses

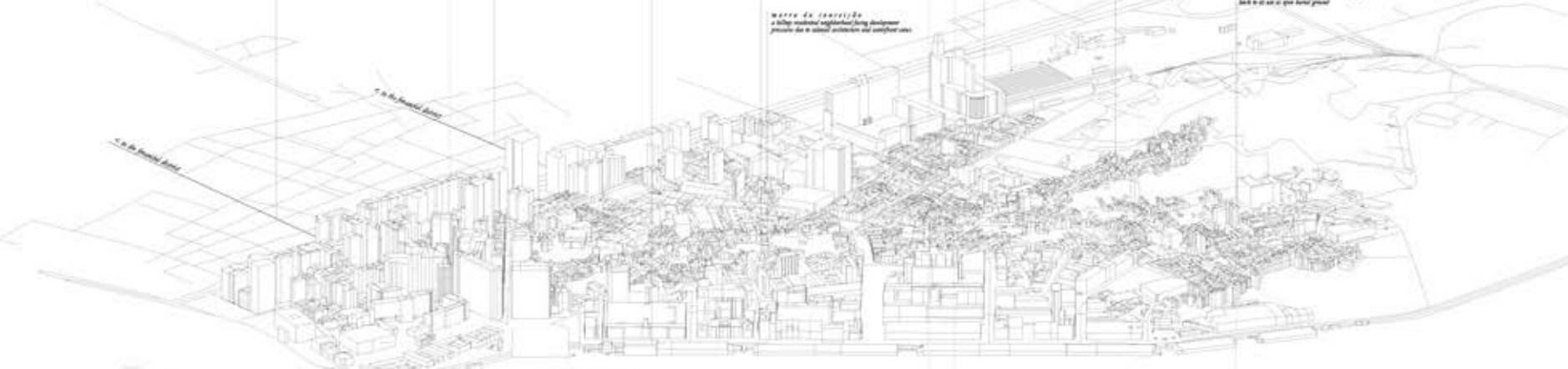

constructed edge
constructed through a series of 100 operations over the last 100 years

THE CONTEMPORARY CITY

remains of old road
a partially 17' ridge for the old road, and is for the distribution of water

deposit
old road bed for the old road, and many more

warehousing
the buildings along the street largely house offices and associated spaces

open barrel ground
open barrel ground for offices that is not used as a site that during the morning period

class hospital
building for offices that is not used as a site that during the morning period

site
one of many pieces of site in the area for the purchase and sale of the area

delta
designed by Oscar Niemeyer in 1954, the Douglas, in 1954

arrival
the dock marking the point of arrival for the area

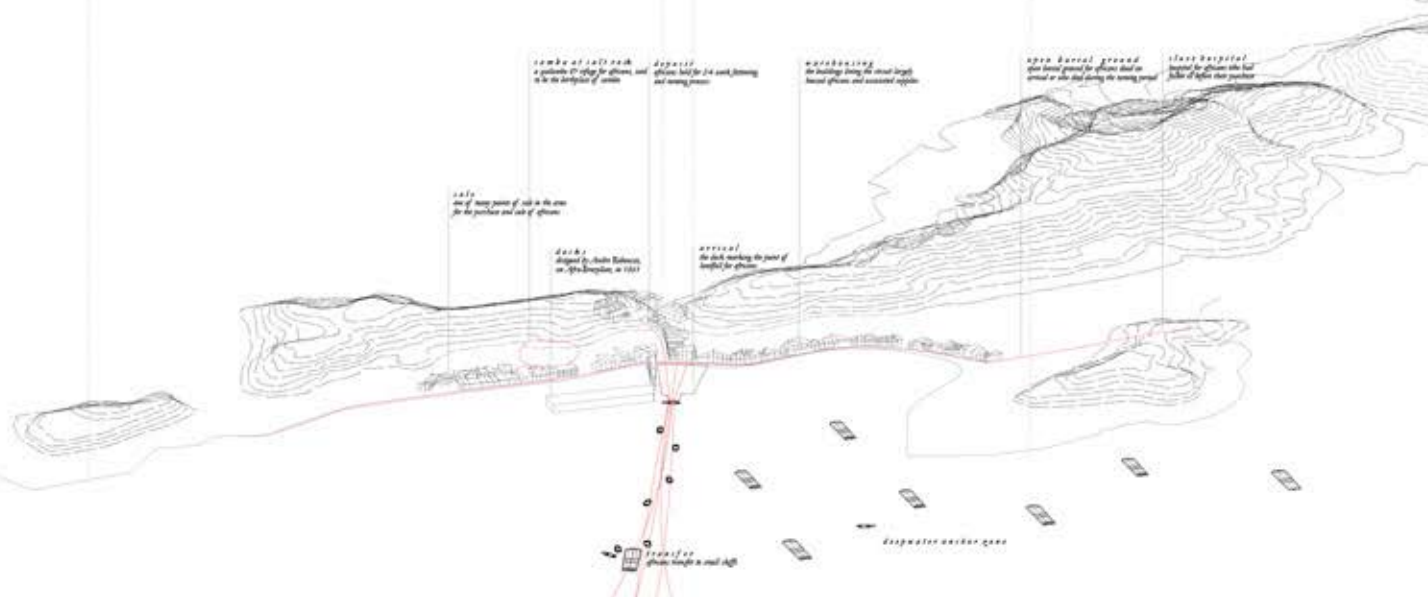

terminal
former terminal and rail stop

deepwater anchor gate

jetway
jetty built through the mouth of the Caramuru Bay, following 7 or 8 months of work

THE HISTORIC VALONGO WHARF COMPLEX



Praça da Harmonia

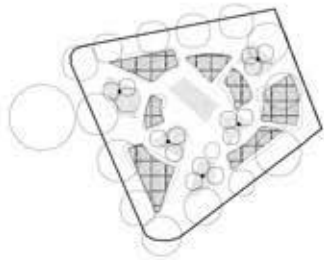

*Valongo Pier
Archaeological Site*



*Afoxé Filhos
de Gbandi*

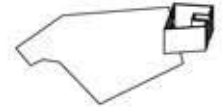

Quilombo da Pedra do Sal

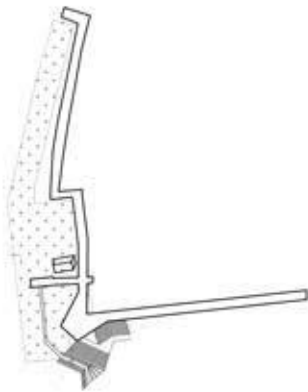

*Largo
do Depósito*



Rua Sacatara Cabral



Tir-Sea

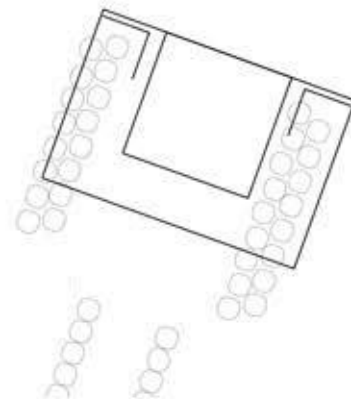

Pilea spicata
Cavendish Herbar. (P. spicata)



Antennaria spicata
Cavendish Herbar. (Antennaria spicata)
"Antennaria" in the original text is misspelled as "Antennaria".
The specimen is a dried plant with a central stem and several long, narrow, lanceolate leaves. The roots are visible at the base.



Antennaria spicata
Cavendish Herbar. (Antennaria spicata)



Pilea spicata
Cavendish Herbar. (P. spicata)



Pilea spicata
Cavendish Herbar. (P. spicata)



Lycopersicon
Cavendish Herbar. (Lycopersicon)



Quercus spicata
Cavendish Herbar. (Quercus spicata)



Quercus spicata
Cavendish Herbar. (Quercus spicata)
The specimen is a dried plant with a central stem and several long, narrow, lanceolate leaves. The roots are visible at the base.



Quercus spicata
Cavendish Herbar. (Quercus spicata)







heaven

Branching trunk
linked to the crown of humanity

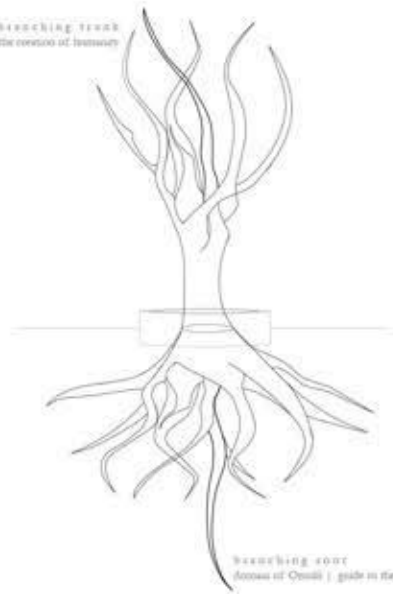

searching root
Arms of Omali | guide in the unknown and the quiet

earth

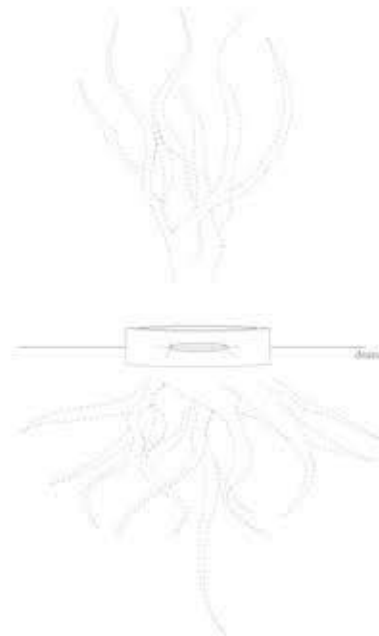
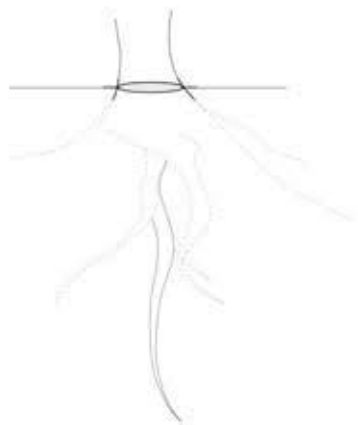

Branching trunk
linked to the crown of humanity

searching root

Arms of Omali | guide in the unknown and the quiet

earth





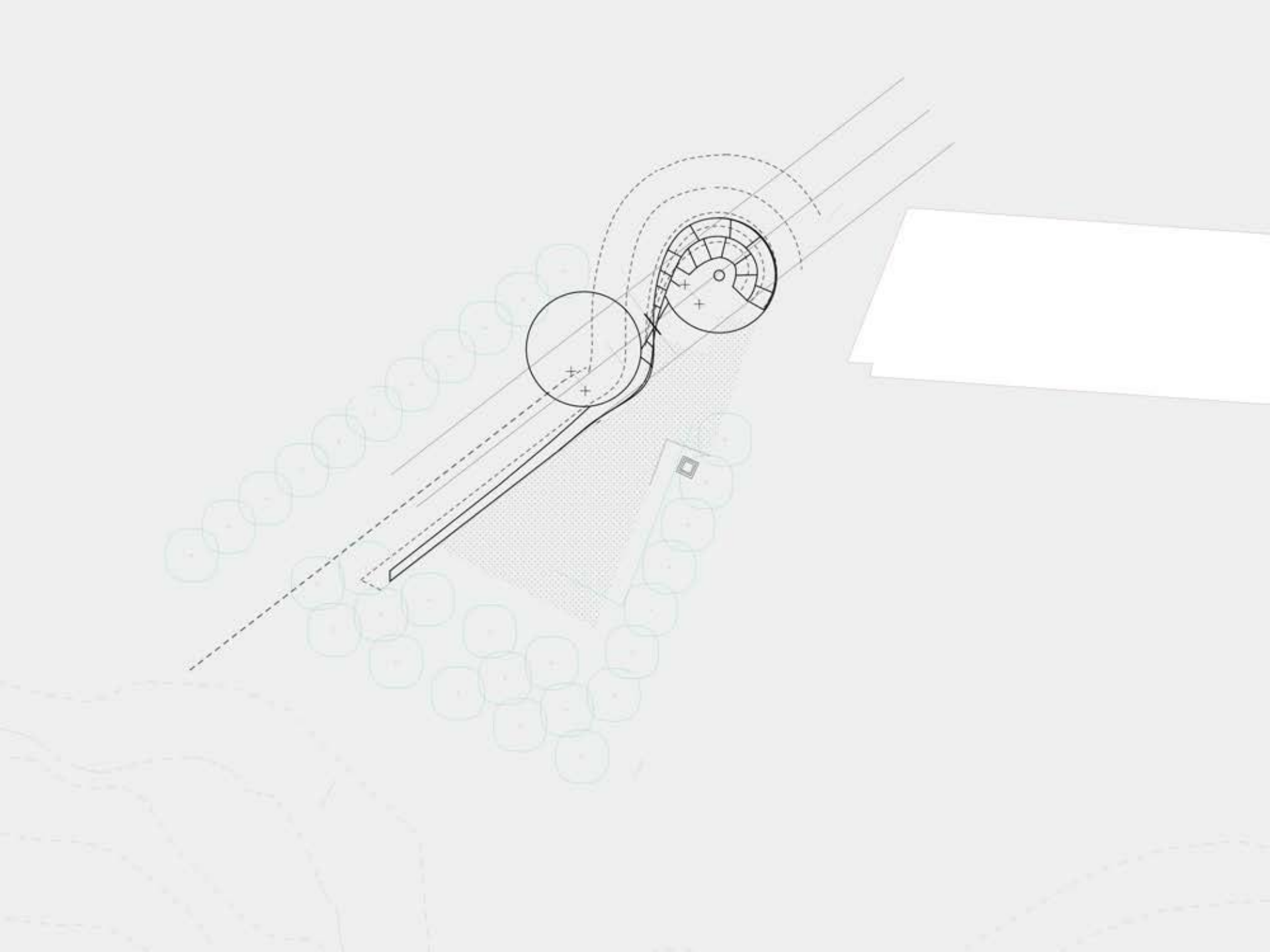



a planta de desembarcamento de arribos de ultralivros. Daqui, só a frente para dois barcos.





slave era depauper
anchor zone

skiff passage
to wharf

PEQUENA
ÁFRICA

SAUDE

VELA DA
VIDÊNCIA

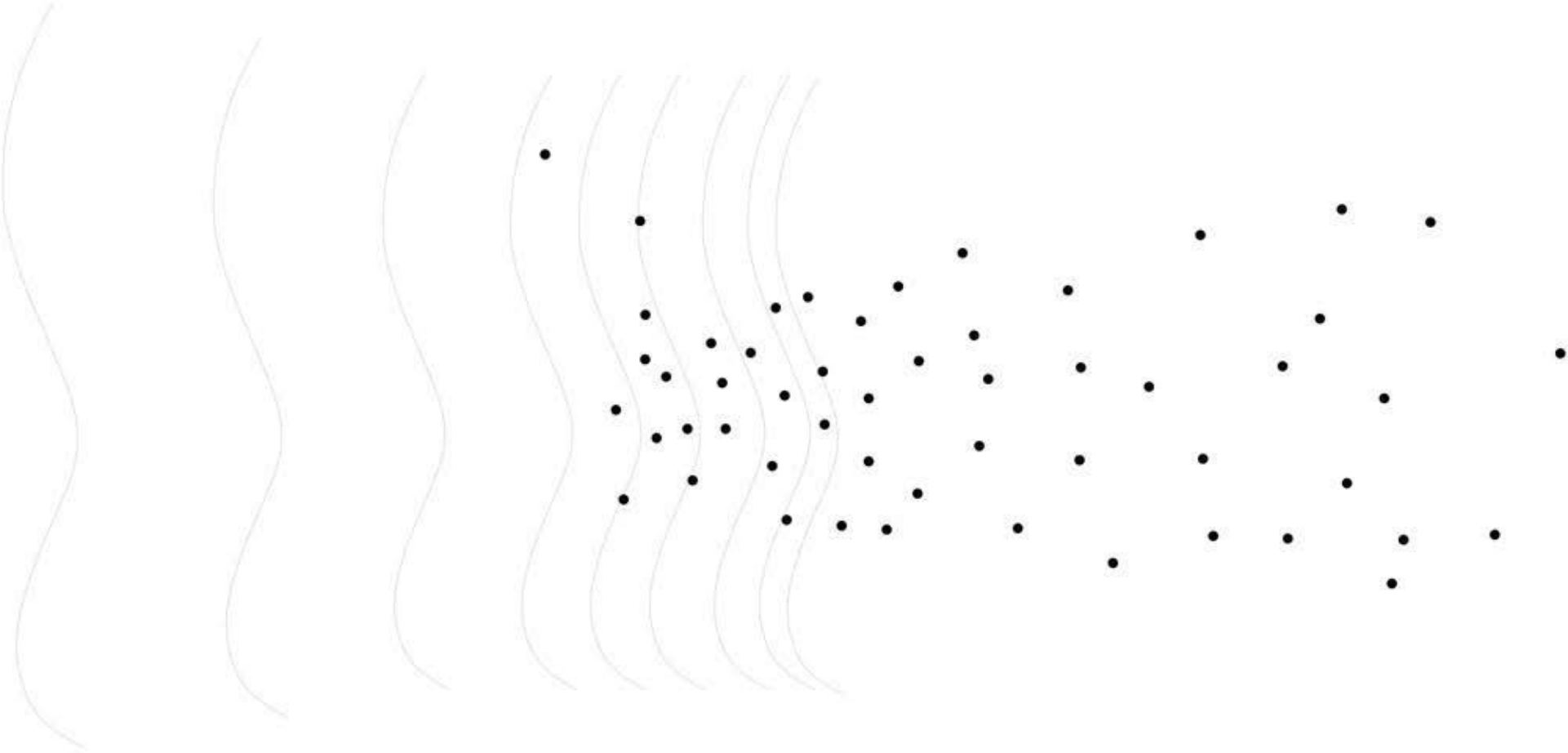

Constructed Edge

Plaza at Water's Edge

New Light Rail

Cruise terminal relocated to new wharf

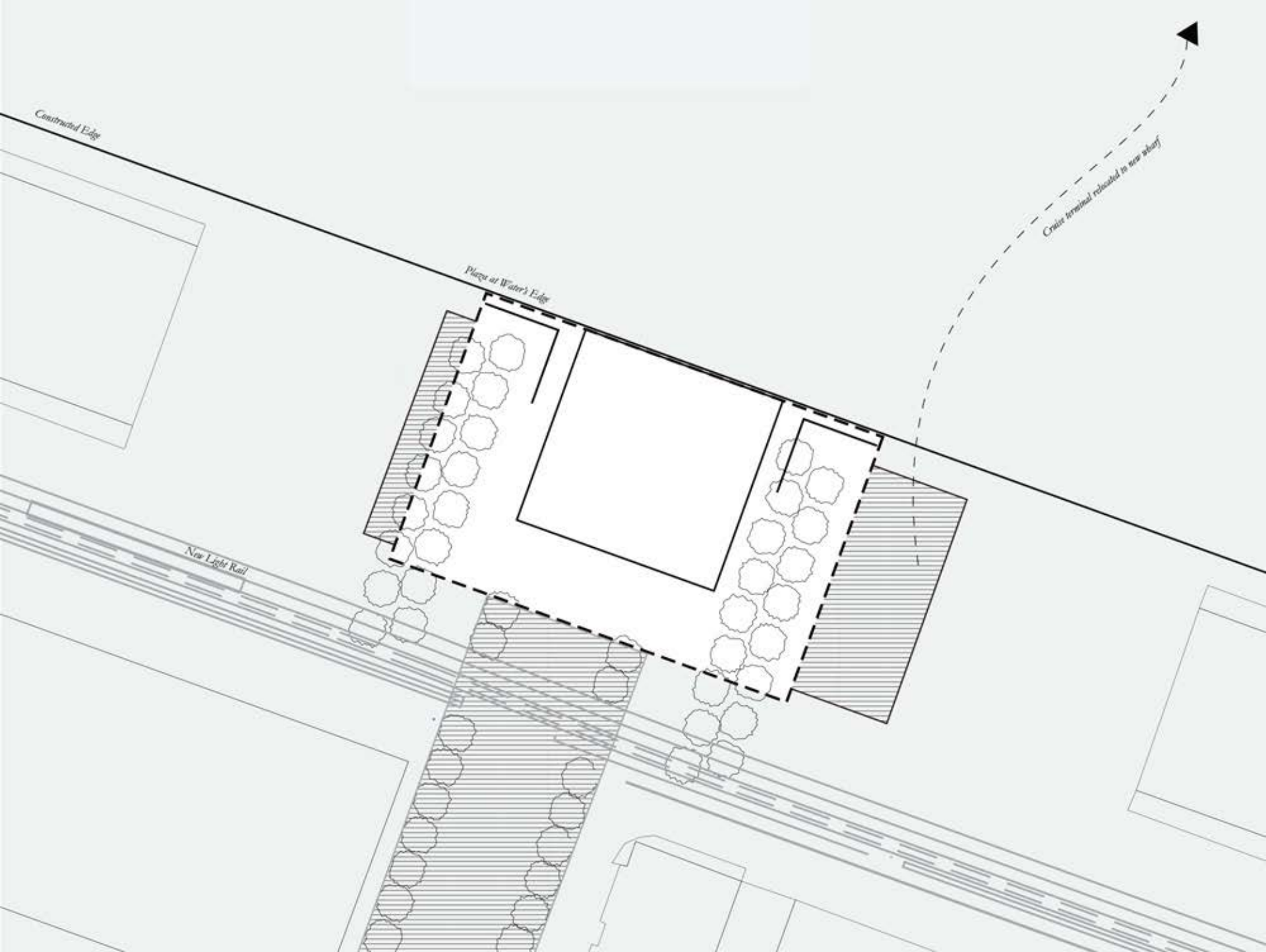

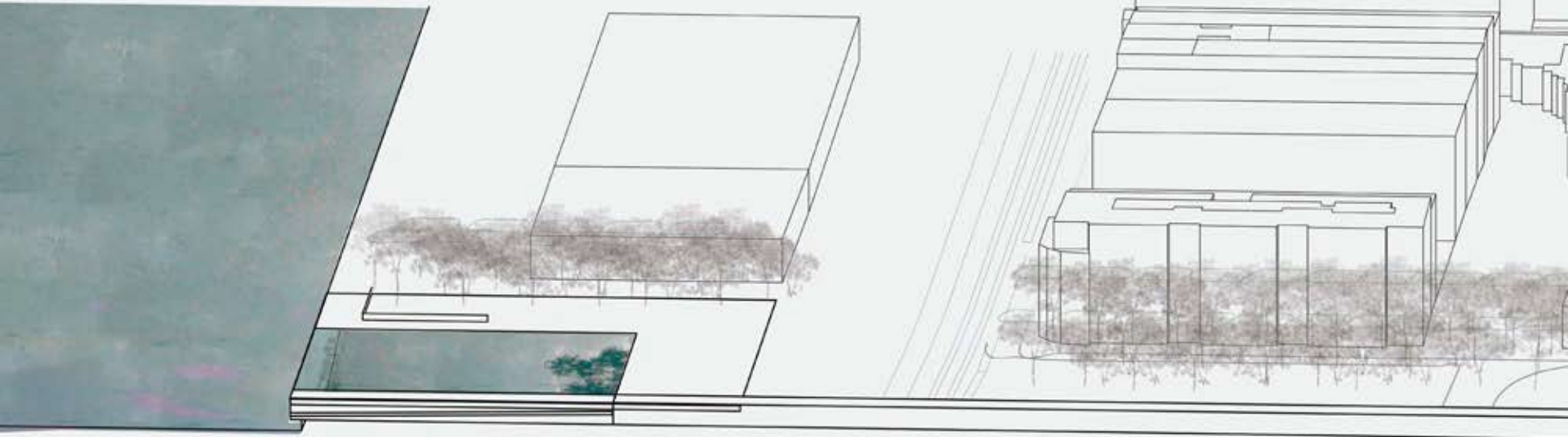





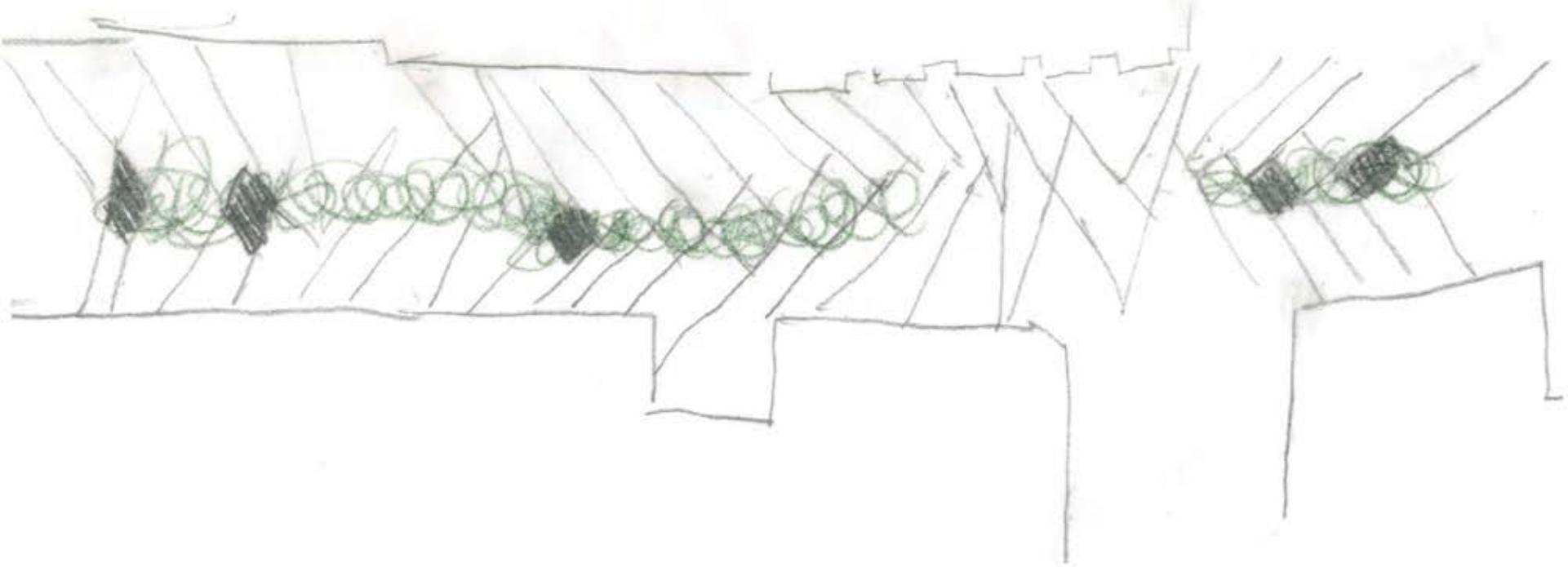
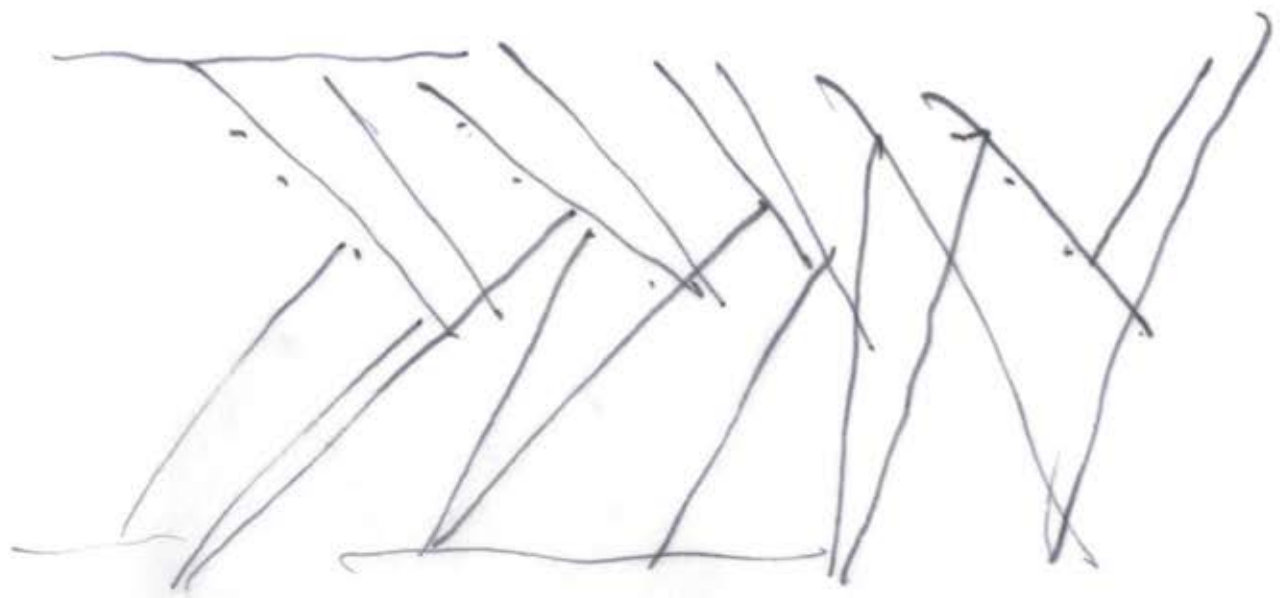

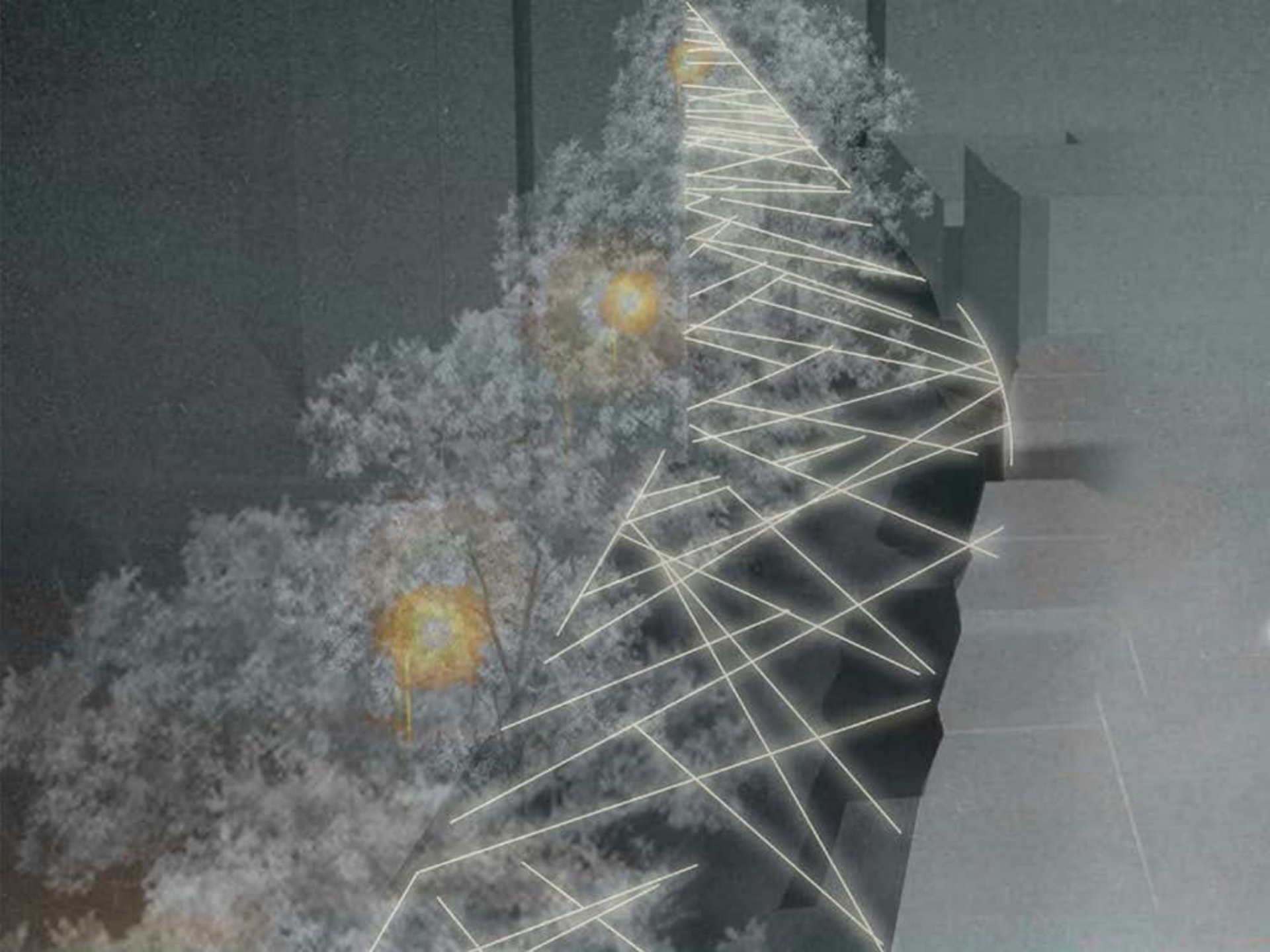



inscription

planting

seating

Upon arrival, they were taken to the open burial ground, located under this earth.





o cemitério dos pretos mortos





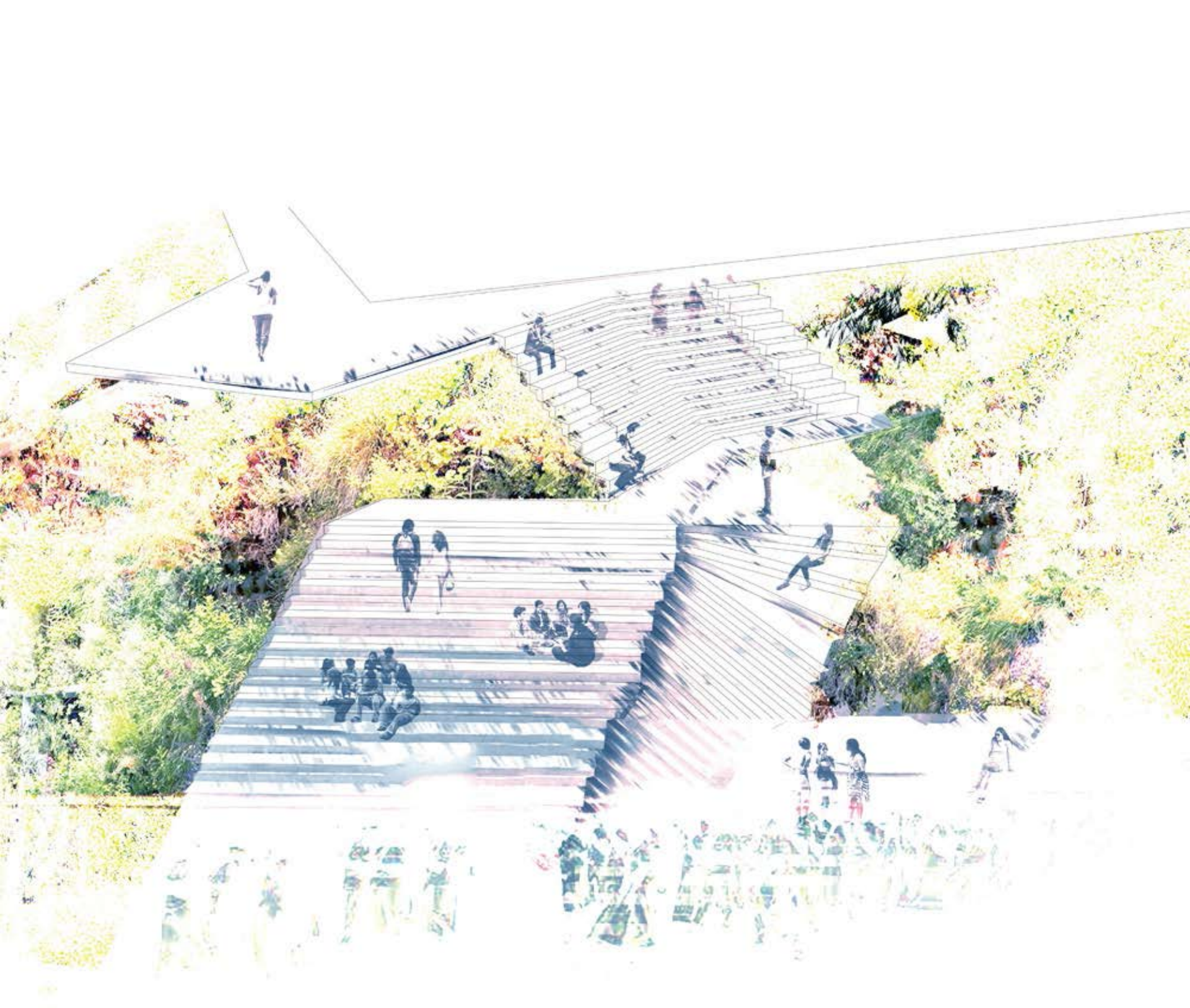







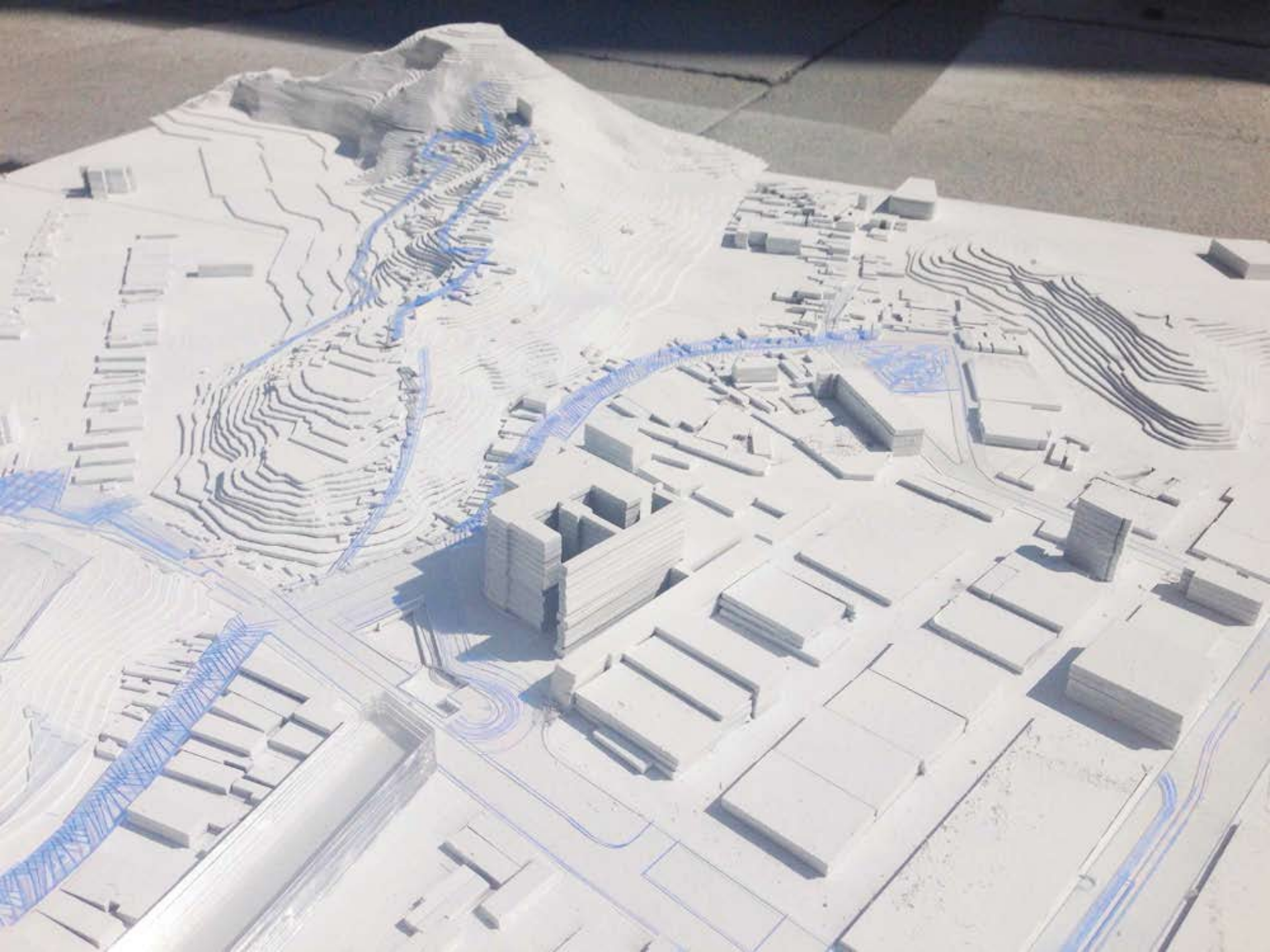

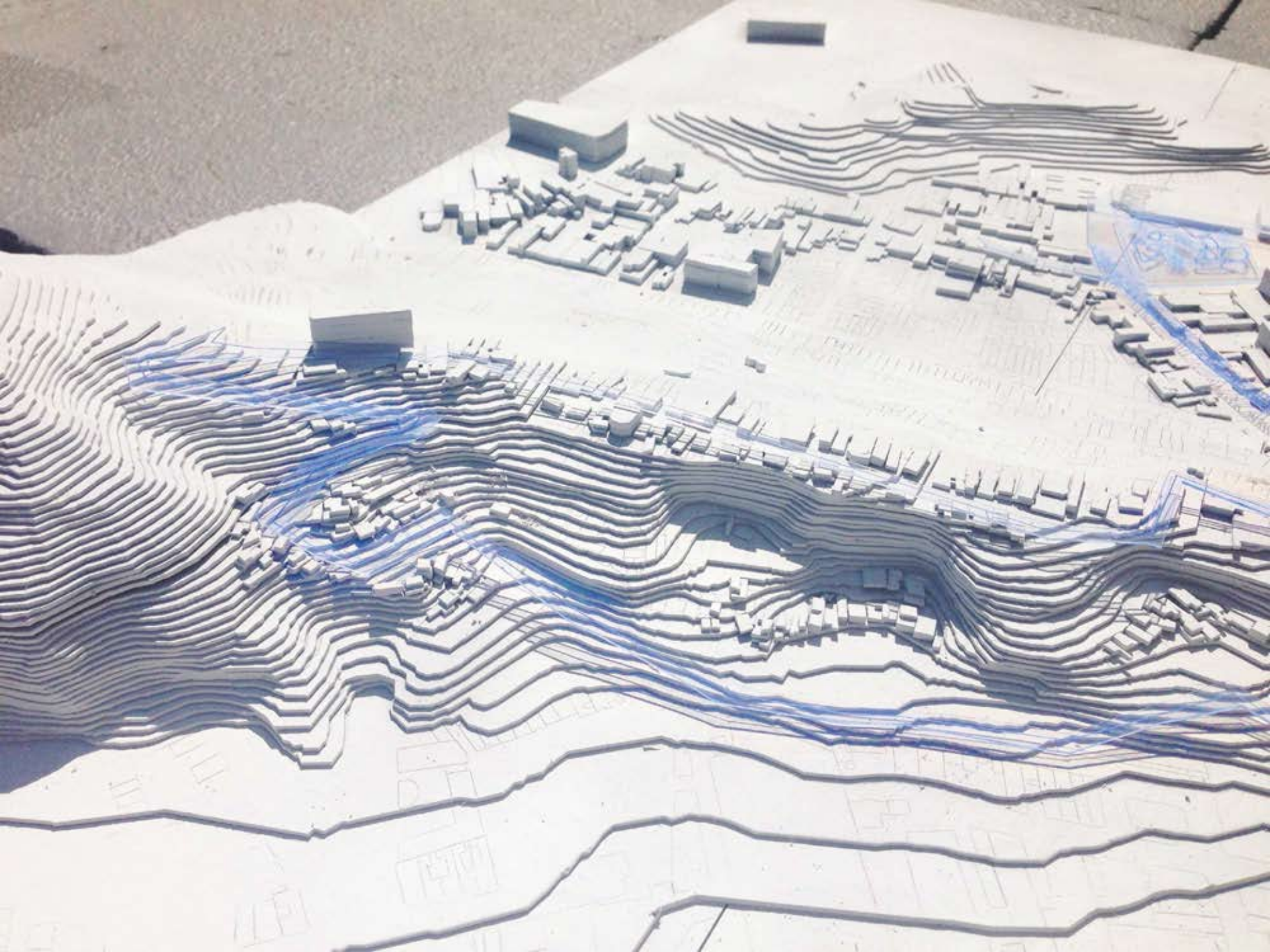

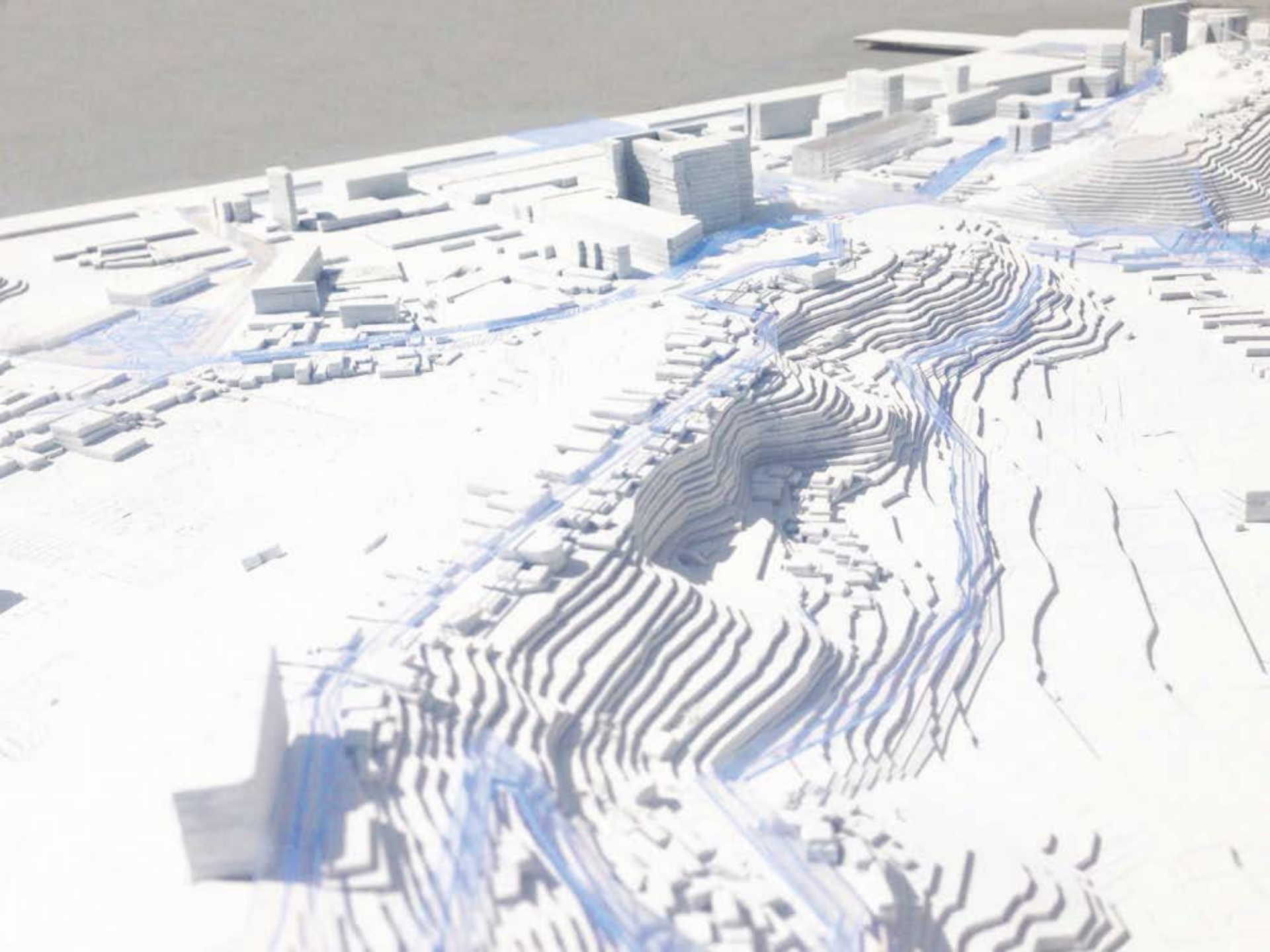

2. Advancing Engagement Methods

2. Advancing Engagement Methods

Project: Africatown Summer 2018 Programming

Location: Seattle, WA

Organization: Design In Public
& Africatown Community Land Trust

DESIGN TOWN HALL

WALTER

HOOD

+

NMADILI

OKWUMABUA



CO-PRESENTED BY



DESIGN
IN PUBLIC.





AFRICATOWN
SEATTLE

LOS
ANGELES





PLAN
1/2000

PLEA MARKET

23RD AVE

KIOSK
KOMMUNAL

E. CHERRY ST

COMING SOON!

NEW CONSTRUCTION

in

CENTRAL SEATTLE



6 BRAND **NEW ROWHOUSES**

POWELL BARNETT

COMING SOON

POWELL BARNETT

POWELL BARNETT
EDUCATION
POWELL BARNETT PARK

EDUCATION — POWELL BARNETT PARK



BROUGHT BY



IN PARTNERSHIP WITH



UJAMAA
COMMUNITY

COMINGSOONAFRICATOWN.COM



COMING SOON LAVIZZO

LAVIZZO

HEALTH AND WELLBEING — LAVIZZO PARK



PRATT LAVIZZO MIDTOWN POWELL BARNETT

BROUGHT BY



IN PARTNERSHIP WITH



COMINGSOONAFRICATOWN.COM





PRATT LAVAZZO MIDTOWN POWELL BARNETT

COMING SOON

HOME ART PLAY — PRATT PARK

BROUGHT BY AFRICATOWN

IN PARTNERSHIP WITH RUST HIBELSH MIDTOWN

COMINGSOONAFRICATOWN.COM



COMING SOON LAVIZZO

LAVIZZO

HEALTH AND WELLBEING — LAVIZZO PARK



PLANNED BY LAVIZZO MIDTOWN POWELL BARNETT

BROUGHT BY

IN PARTNERSHIP WITH



COMINGSOONAFRICATOWN.COM

09 23

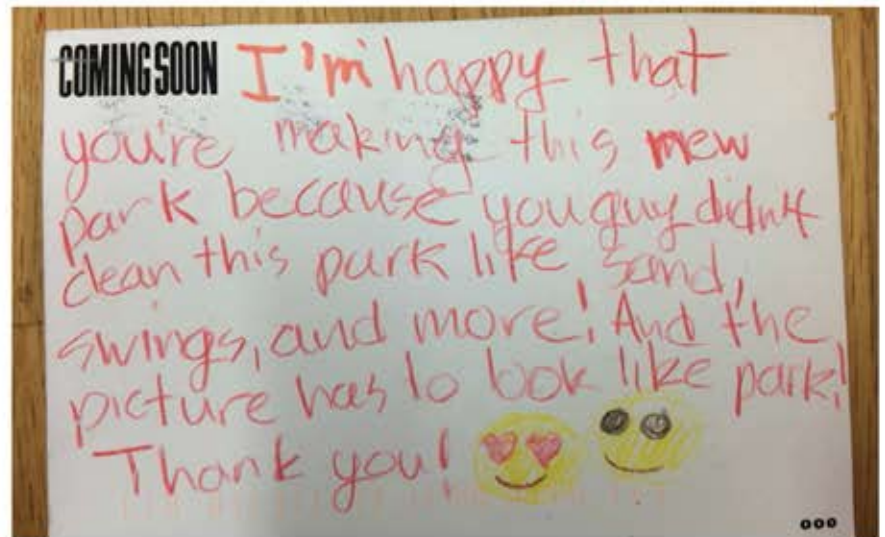











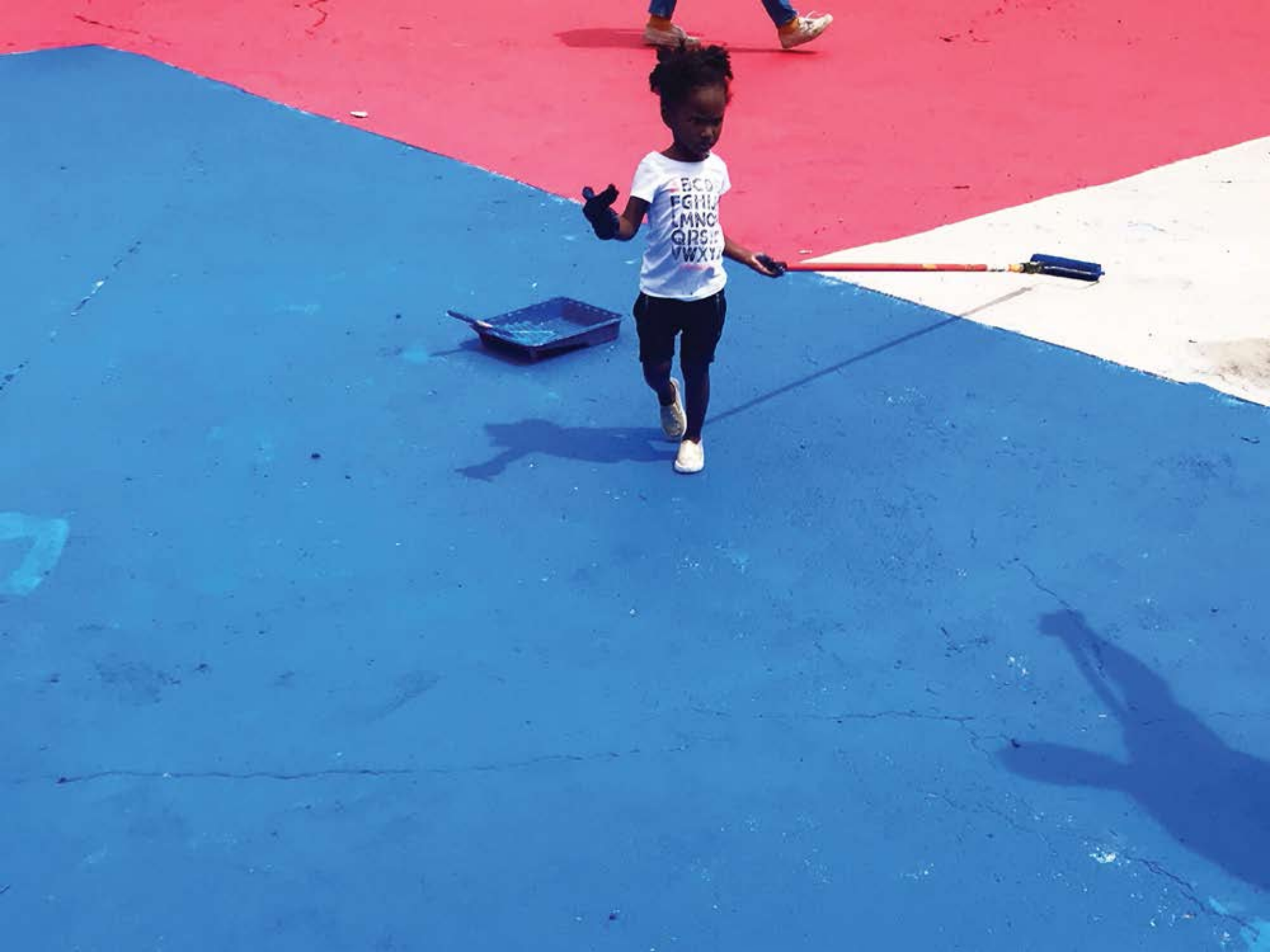

BCD
FGHIJ
LMNO
PQRST
VWXYZ

United States
Post Office 

World Trade Center





FABRICATON

EARL'S GOLF AND STYLES















3. A Challenge to Architecture

3. A Challenge to Architecture

Project: Mander Rec Center Vision Plan

Location: Philadelphia, PA

Organization: Fairmount Park Conservancy
& Strawberry Mansion CDC

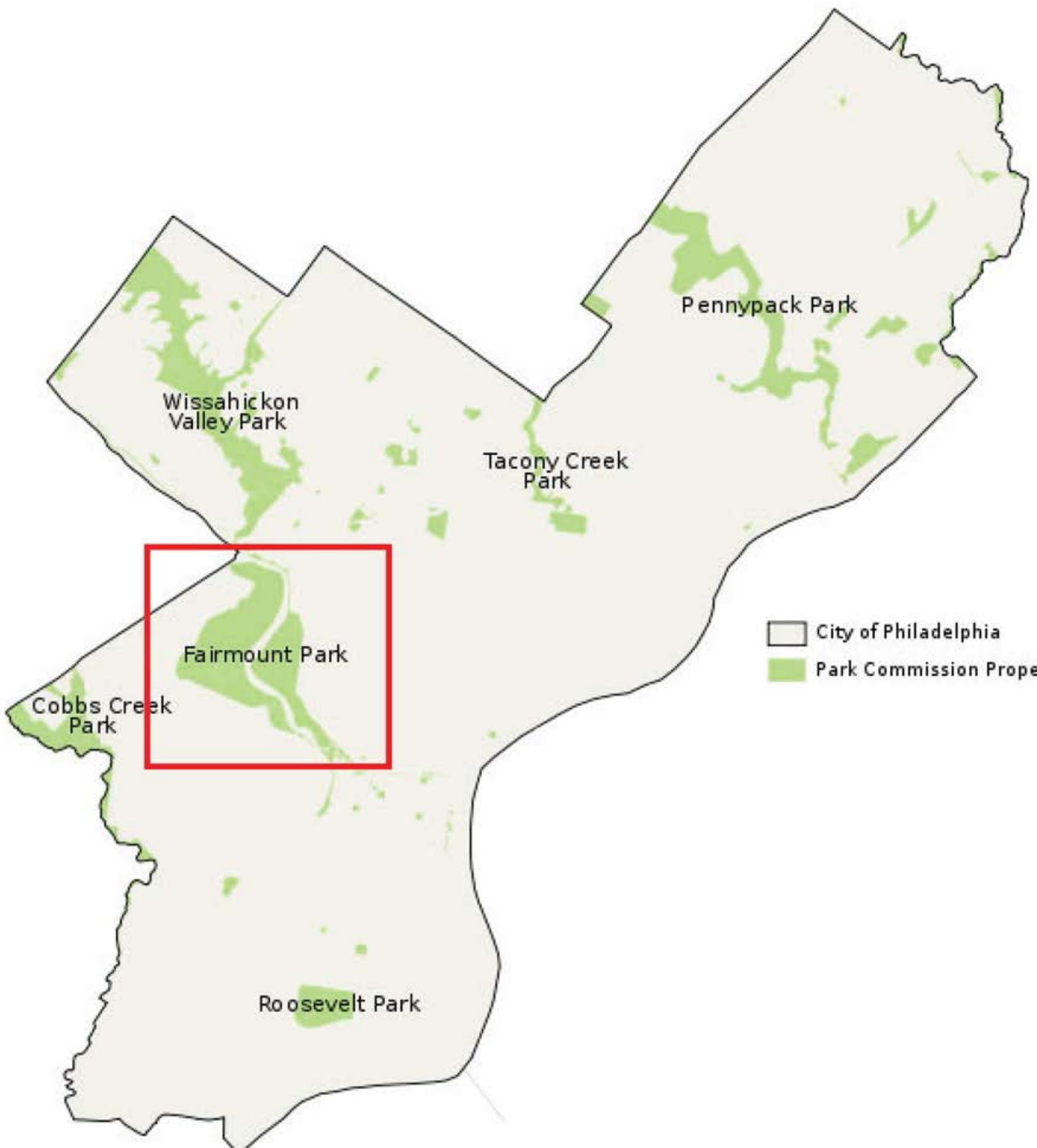

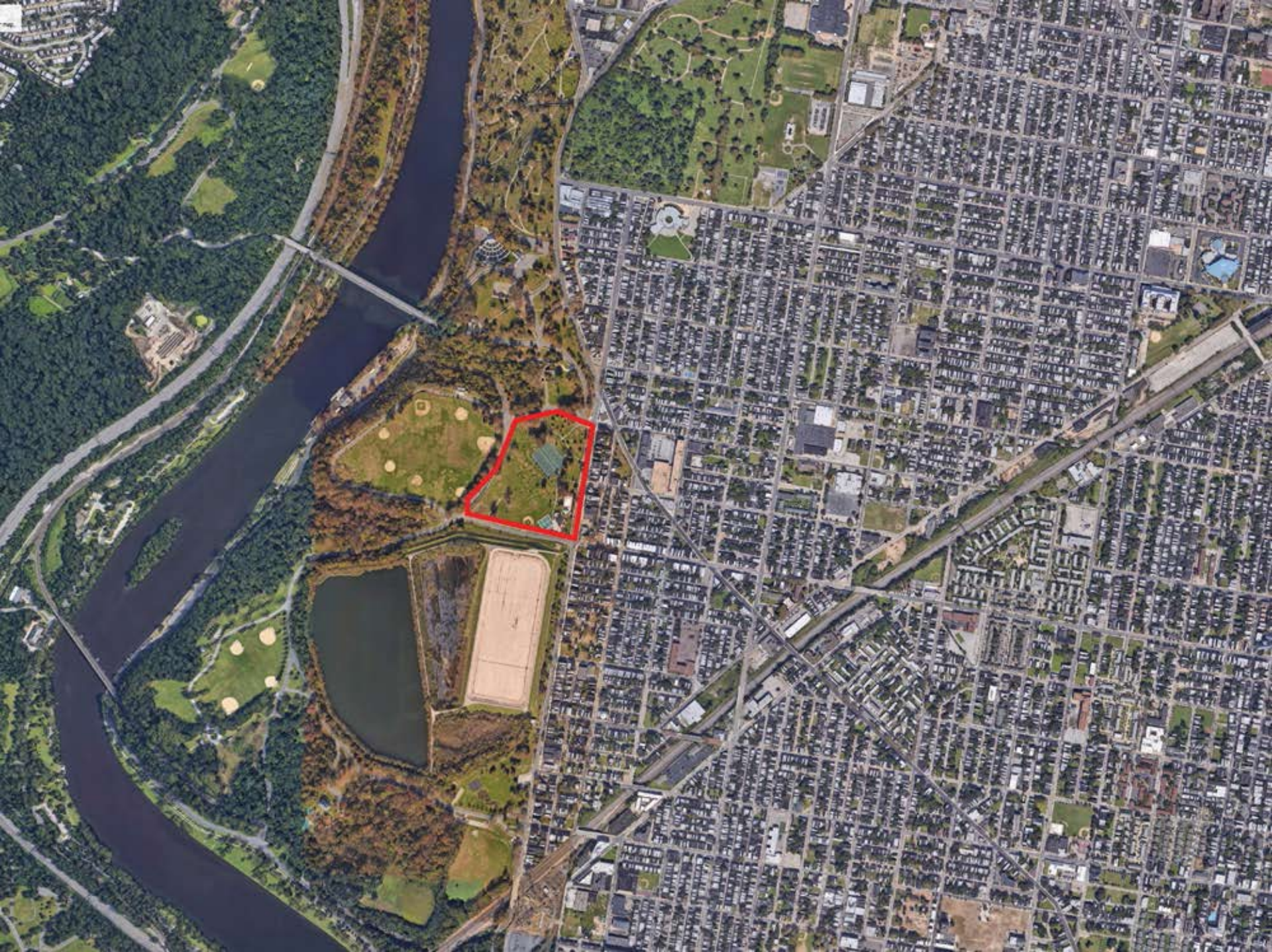





CONTEXT

SHORT-TERM VISION

LONG-TERM VISION

Walking access to Randolph Creek is visible just a few hundred feet from Strawberry Mansion's main connection to East Fairmount Park, Joseph Mander Recreation Center.



1
Creating gateway and access improvements in this area can go a long way toward better engaging a North Philadelphia community with nature.



2
While many local residents experience the park through Mander, there is nothing to guide them to the beautiful slice of nature deeper within the park.



3
Randolph Creek begins in an understated manner, marked by a small wetland and limited pedestrian access.



4
A stretch of the Boxers' Trail hugs the creek but veers left before the Schuylkill River, as there is no way to safely cross the high-speed traffic and use the river trail.



5
Randolph Creek is channeled under Kelly Drive before it flows into the Schuylkill River.



MANDER REC CENTER GATEWAY

STRAWBERRY MANSION GATEWAY

BREWERY TOWN GATEWAY

EAST PARKSIDE GATEWAY

WEST PARKSIDE GATEWAY

HOME

WHY EAST AND WEST FAIRMOUNT PARK

THE BIG VISION

FIRST STEPS

FOCUS AREAS

<

>

Existing Site













AUGUST 21, 1952 15c
A JOHNSON PUBLICATION

BLACK SUPERMEN

JET

THE WEEKLY NEGRO NEWS

ESTELLE PRICE:

She hopes to
find stage fame
after chorus line
career



MUST CHORUS GIRLS BE PLAYGIRLS?

Now I have seen monuments:
Great geometric heaps of stone,
Lifeless towers raised to keep alive the dead;

But I ask,
Cannot a monument that breathes be built?
A grateful people are bigger than all the tall piled stones
In our wide and waiting world;
A grateful people are wise
When their living grows into a growing monument.
And I ask,
Will not a monument breathe for Mander?

Spring out of the hearts of people who
Have grown wise in the ways of brotherhood
As taught by brave dead Mander?

And I ask,
When you walk through the spring that won't come this year for
Joseph E. Mander, Senior
Will you turn those fingers that point to say
"That's where a hero died"
Back to yourselves –
Point to your heart
Saying,
"But this is here he lives!"



ark.org

TENNIS

org

PHILADELPHIA SIXERS

I
♥
MANDER



Mander is a place to...

Mander is a place to gather with the community

Mander is a place to have fun and meet people

Mander is a place to gather a place to have fun

Mander is a place to Play

Mander is a place to play football

Mander is a place to _____

Mander is a place to _____

Mander is a place to _____

Mander is a place to _____

Mander is a place to _____

Mander is a place to _____

Mander is a place to _____

Mander is a place to _____

Mander is a place to _____

Mander is a place to Explore the park

Mander is a place to enjoy the park and relax

Mander is a place to have family gathering

Mander is a place to meet neighbours

Mander is a place to Educate

Mander is a place to Enjoy

Mander is a place to _____

Mander is a place to _____

Mander is a place to _____

Mander is a place to _____

Mander is a place to _____

Mander is a place to _____

Mander is a place to _____

Mander is a place to _____



Mander is a place to enjoy personal activities

Mander is a place to gather with family

Mander is a place to _____

Mander is a place to _____

Mander is a place to _____

Mander is a place to _____

Mander is a place to _____

Mander is a place to _____

Mander is a place to _____

Mander is a place to _____

Mander is a place to _____

Mander is a place to _____

Mander is a place to _____

Mander is a place to _____









Collages with interpretive diagrams

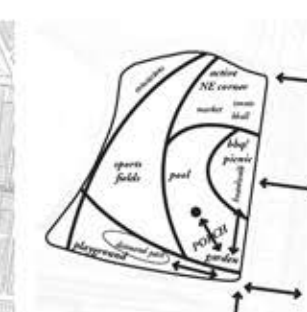
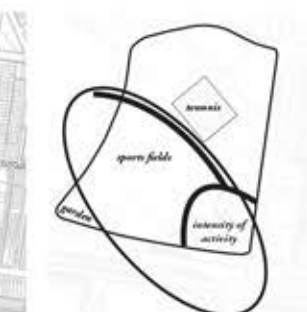
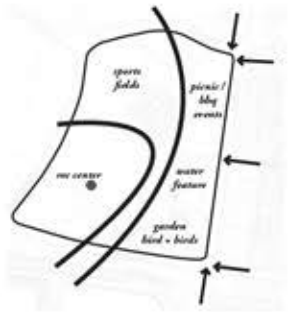
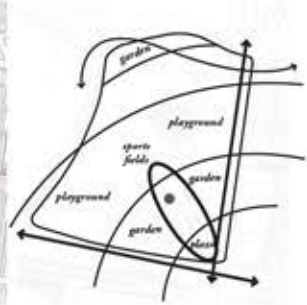
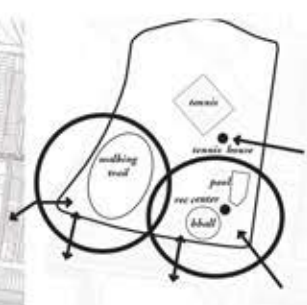
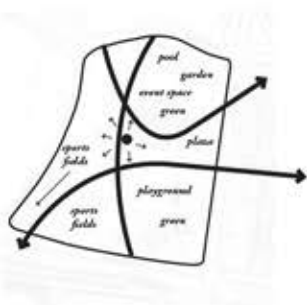

#1. Activate 33rd Street, including north side

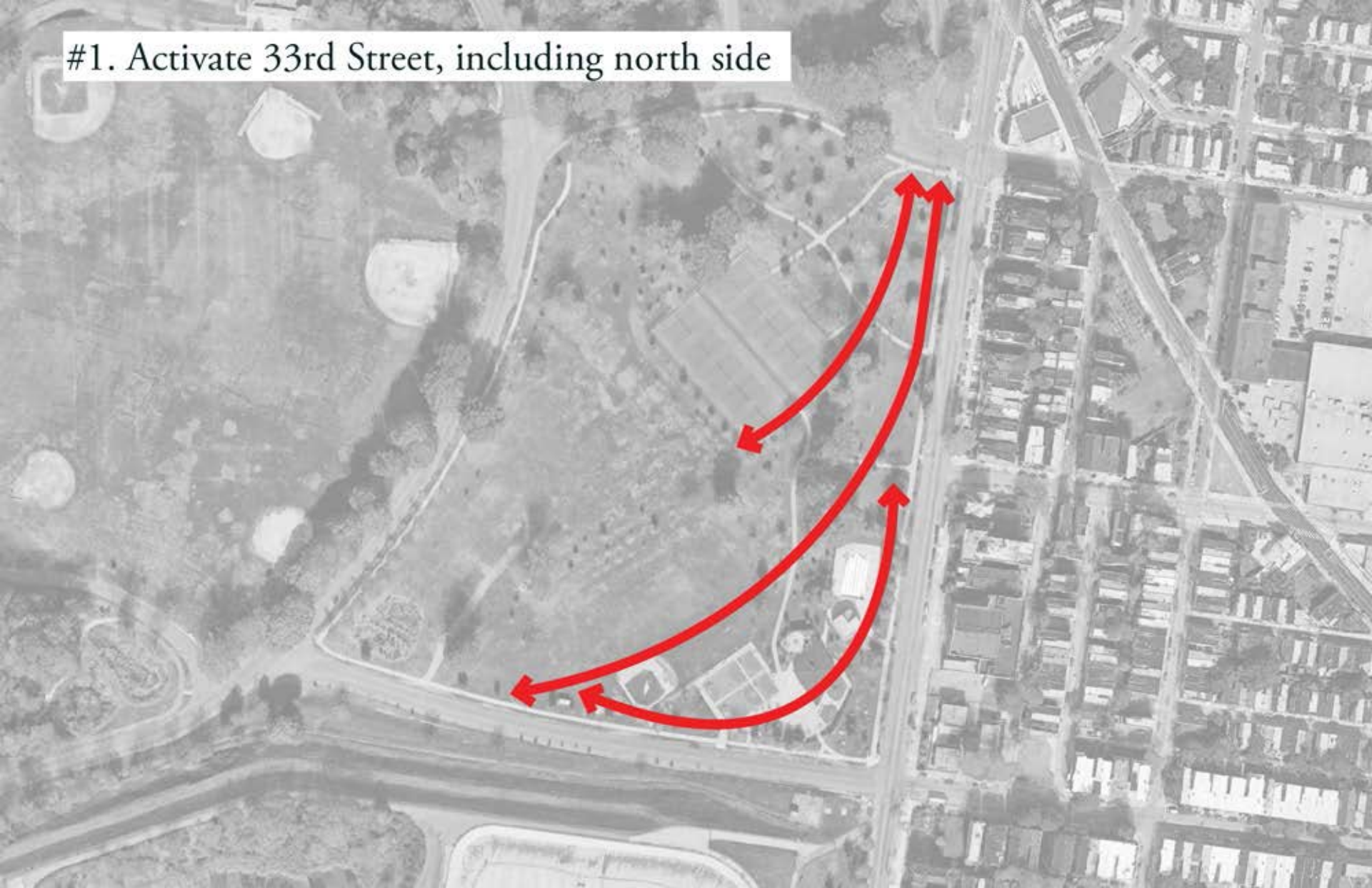

#2. Bring People IN to the campus

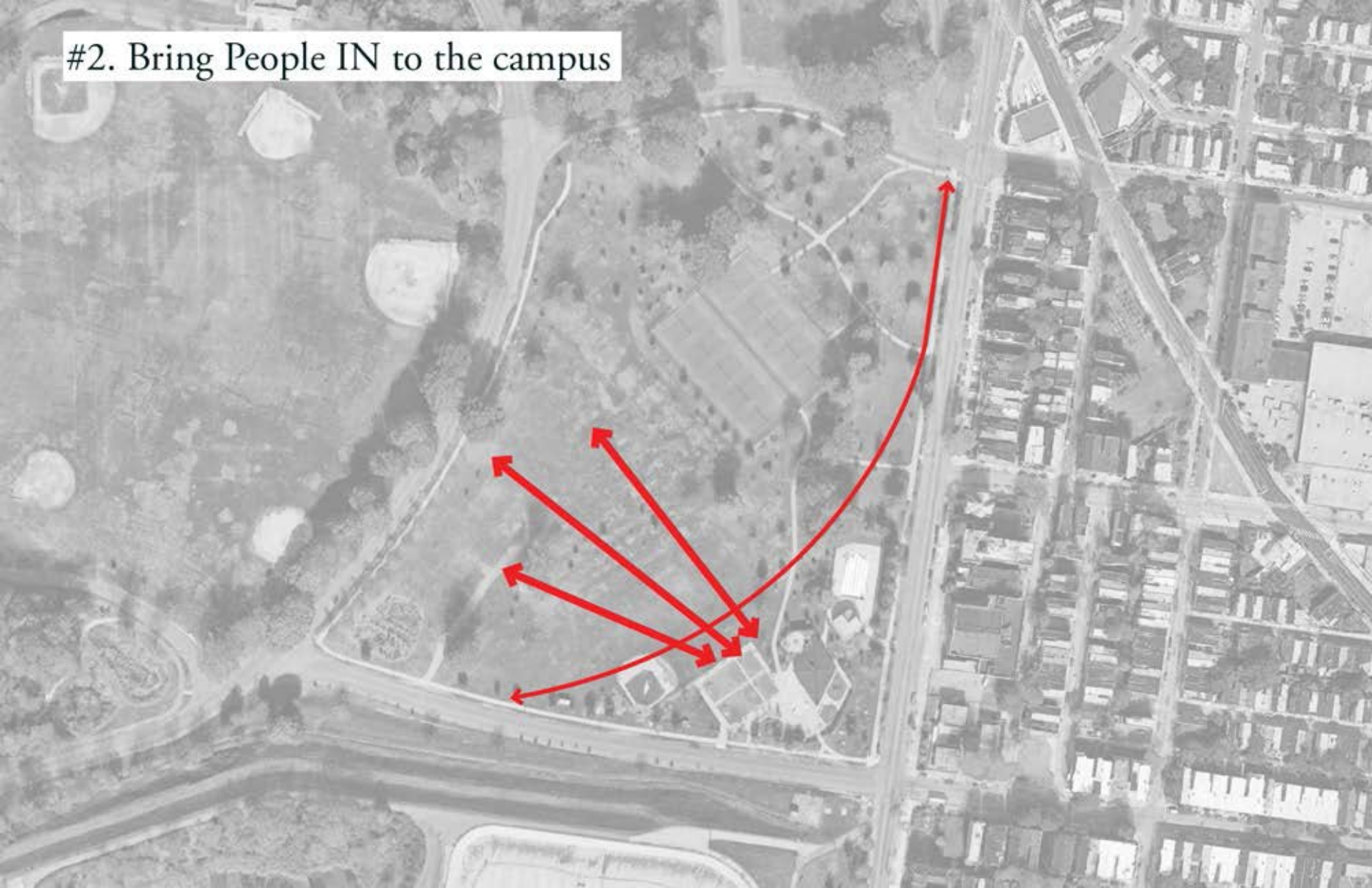

#3. Clear Loop Around the Fields



Vision Plan Diagram

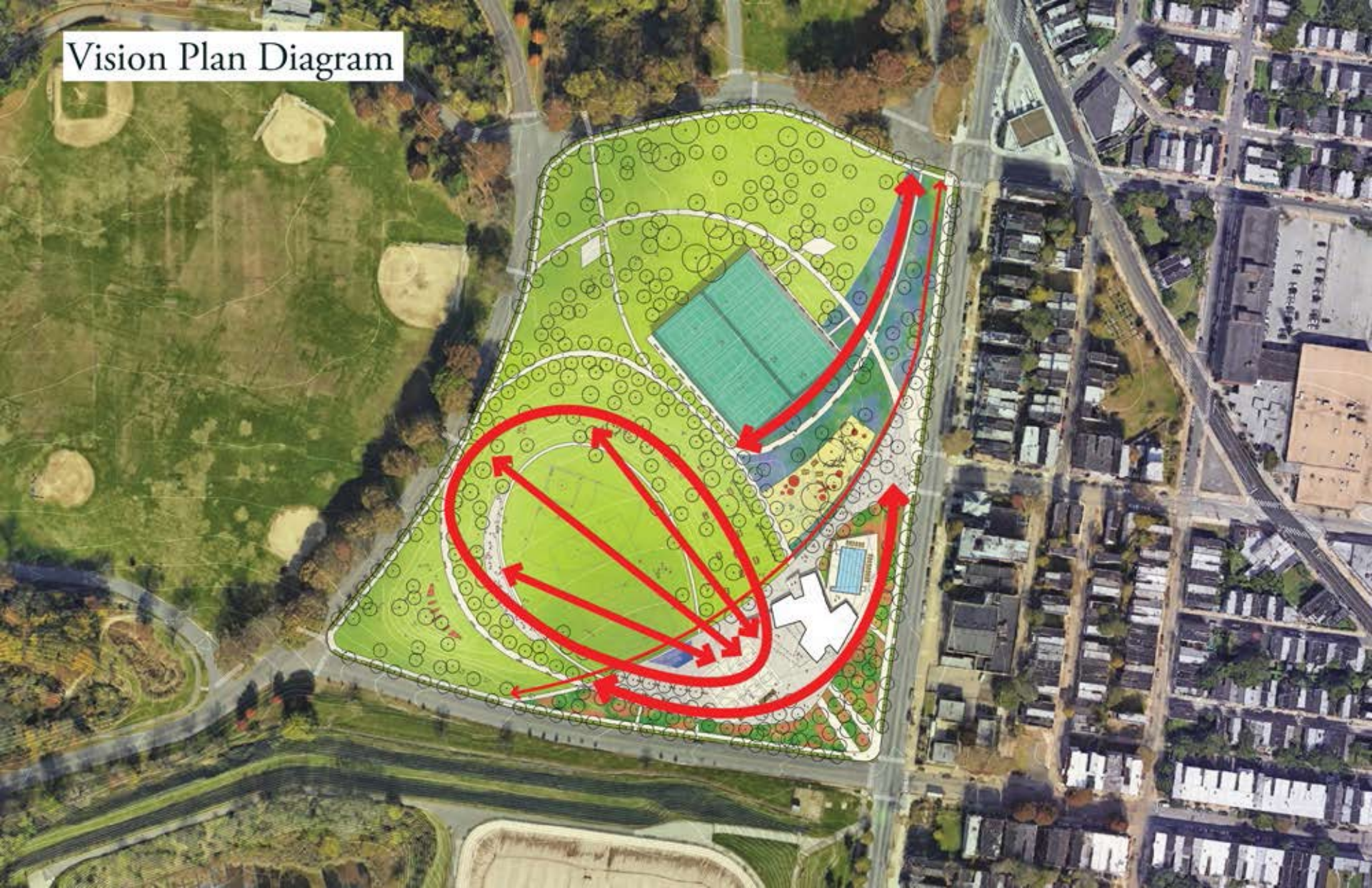

Vision Plan



Memory Plan





LEGEND

MANDER PLAZA

- ① Rose Garden
- ② Mander Rec Center
- ③ Pool & Deck
- ④ Basketball Courts
- ⑤ Mander Memorial Fountain
- ⑥ Mander Memorial Grove

MANDER FIELDS

- ⑦ Flexible Fields & Event Lawn
- ⑧ Amphitheater Seating
- ⑨ Hill Play Area
- ⑩ Picnic & Cookout Grove
- ⑪ Tennis Courts
- ⑫ Picnic Pavilions

THE GARDEN WALK

- ⑬ Play Area & Splash Pad
- ⑭ Seasonal Garden





LEGEND

MANDER PLAZA

- Rose Garden
- Mander Rec Center
- Pool & Deck
- Basketball Courts
- Mander Memorial Fountain
- Mander Memorial Grove

MANDER FIELDS

- Flexible Fields & Event Lawn
- Amphitheater Seating
- Hill Play Area
- Picnic & Cookout Grove
- Tennis Courts
- Picnic Pavilions

THE GARDEN WALK

- Play Area & Splash Pad
- Seasonal Garden



Connections



to Fairmount Park North

to 33rd North

to Edgely Fields

to Susquehanna

to Randolph Creek

to 33rd South

Coltrane's Paving Pattern

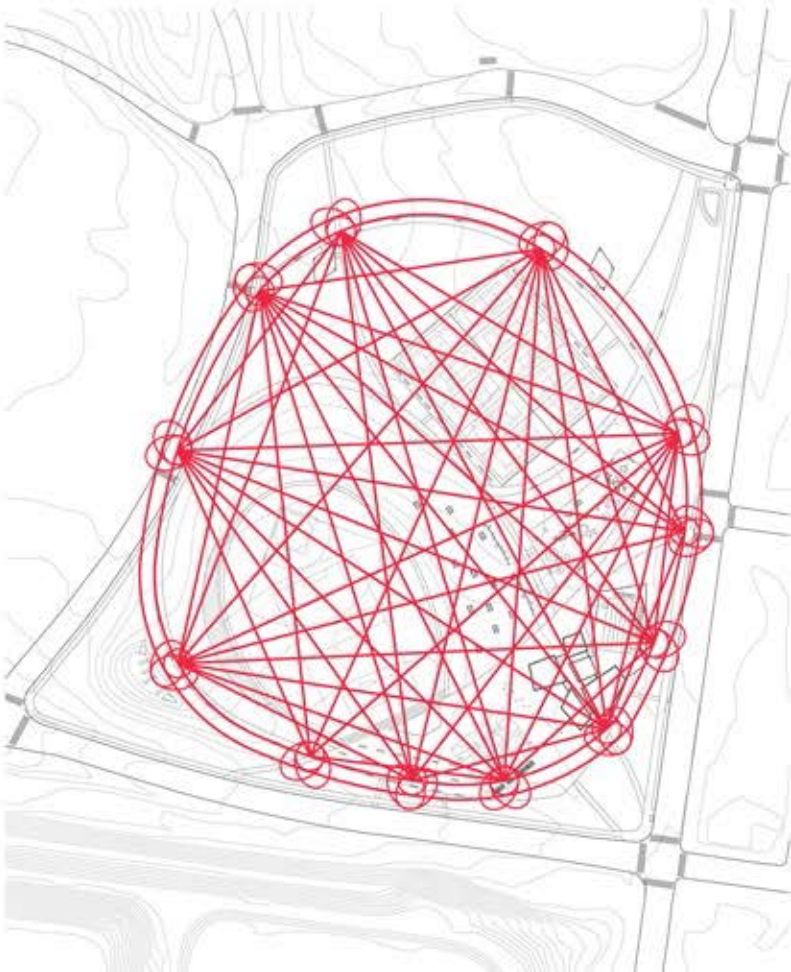
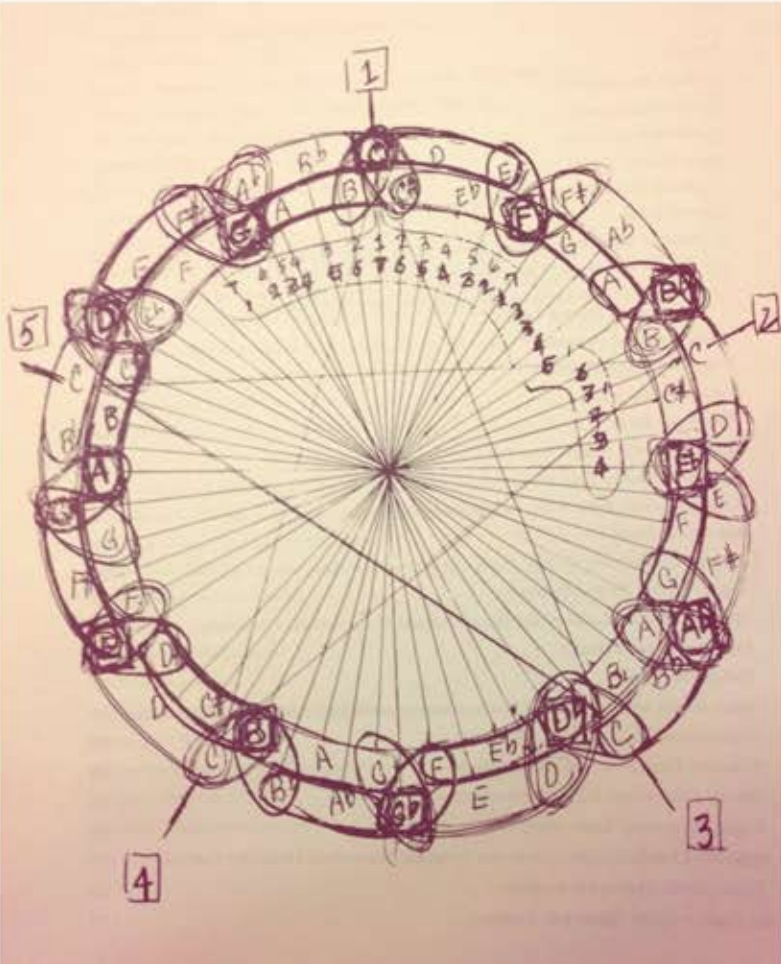

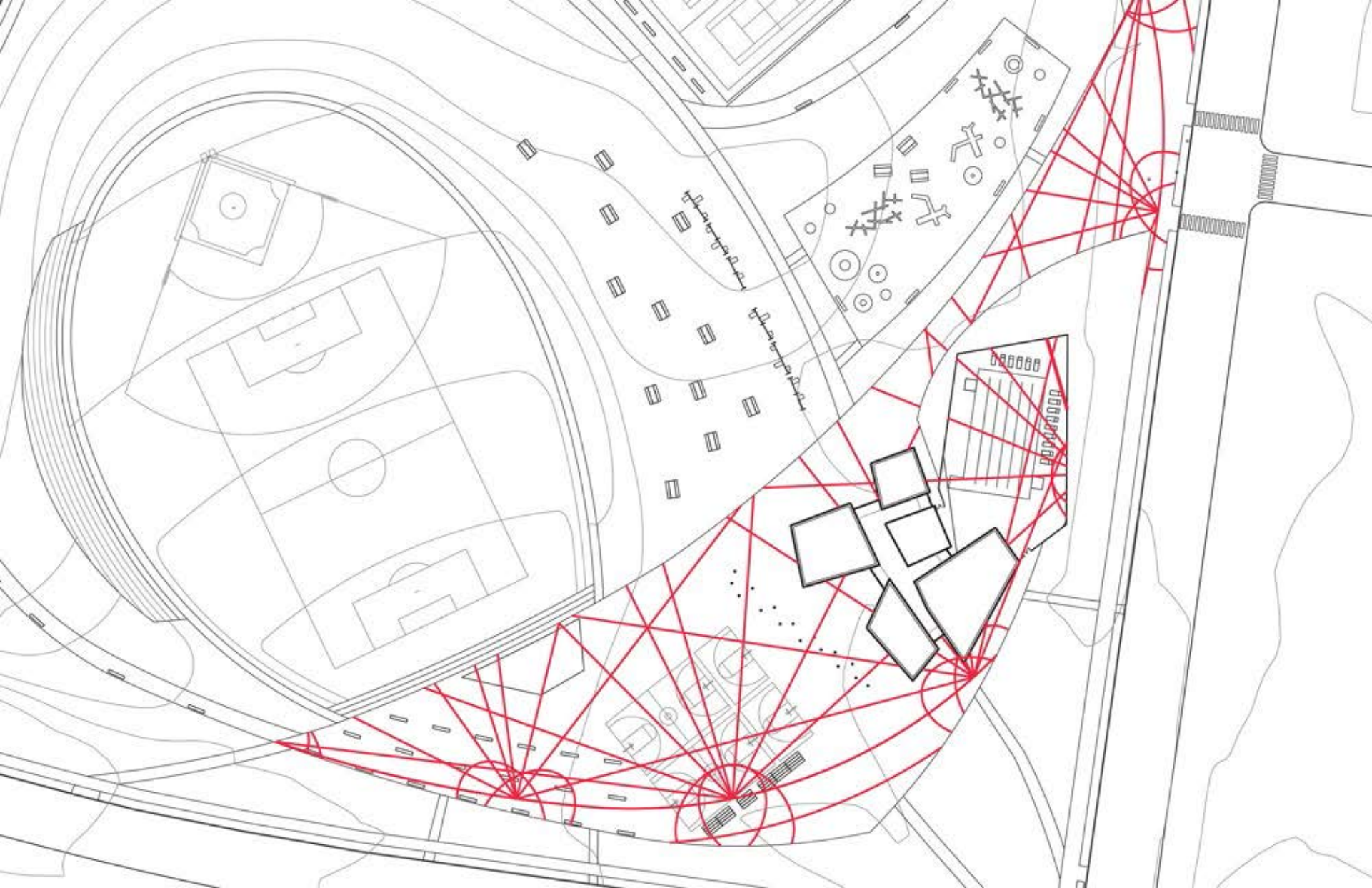



Mander Memorial Grove





Garden Walk



Mander Field



the impact of the architecture organization